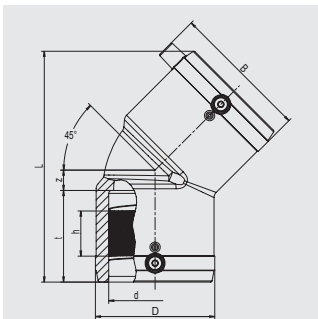

W45**Elbows 45°**

With exposed heating coils for optimal heat transfer, large insertion depth, wide fusion zones plus cold zones at the end and in the middle to prevent the flow of molten material, for use without holding devices.

**PE 100 SDR 11****Maximum working pressure 16 bar (water)/10 bar (gas)**

| d | Order Ref. | Stock-status | BX | PU | D | L | Weight kg/each |
|-----|-------------------|--------------|-----|------|-----|-----|----------------|
| 25 | 616687 ① ② | 3 | 150 | 2400 | 35 | 89 | 0.050 |
| 32 | 612092 | 1 | 50 | 1600 | 43 | 102 | 0.070 |
| 40 | 612094 | 1 | 30 | 960 | 54 | 120 | 0.110 |
| 50 | 612096 | 1 | 20 | 640 | 66 | 136 | 0.175 |
| 63 | 612098 | 1 | 10 | 320 | 82 | 158 | 0.295 |
| 75 | 612100 | 1 | 14 | 252 | 96 | 198 | 0.520 |
| 90 | 612102 | 1 | 8 | 144 | 115 | 232 | 0.810 |
| 110 | 612104 | 1 | 10 | 80 | 138 | 265 | 1.320 |
| 125 | 612106 | 1 | 10 | 80 | 157 | 279 | 1.770 |
| 160 | 615275 | 1 | 4 | 32 | 207 | 377 | 4.410 |
| 180 | 615687 | 1 | 3 | 24 | 228 | 382 | 4.610 |
| 200 | 616264 | 1 | 1 | 18 | 254 | 415 | 6.760 |
| 225 | 615688 | 1 | 1 | 8 | 280 | 450 | 8.290 |

① Design deviates from product description

② minimum order quantity = 1 packaging unit