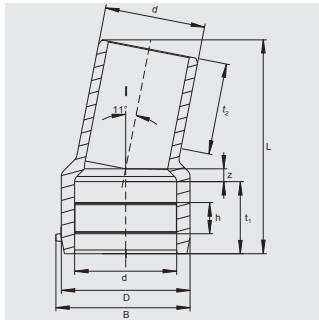

WS11**I/A Elbows 11°**

For universal and stress free changes in direction even in restricted spaces. Optimum flexibility through male/female design. Elbows of 22°, 33° etc. can be set up thanks to multiple application. Coupler side with exposed heating coils for optimum heat transfer, large insertion depth and wide fusion zone. Spigot for processing with FRIALEN MB or UB couplers.

PE 100 SDR 11**Maximum working pressure 16 bar (water)/10 bar (gas)**

d	Order Ref.	Stock-status	BX	PU	D	L	Weight kg/each
110	616139	1	8	144	141	235	0.920
125	616140	1	5	90	160	250	1.250
160	616141	1	8	64	200	295	2.260
180	616142	1	4	32	226	310	3.050
225	616143	1	1	18	280	350	5.280