

PS 180 PS 400 PIPE SCRAPER

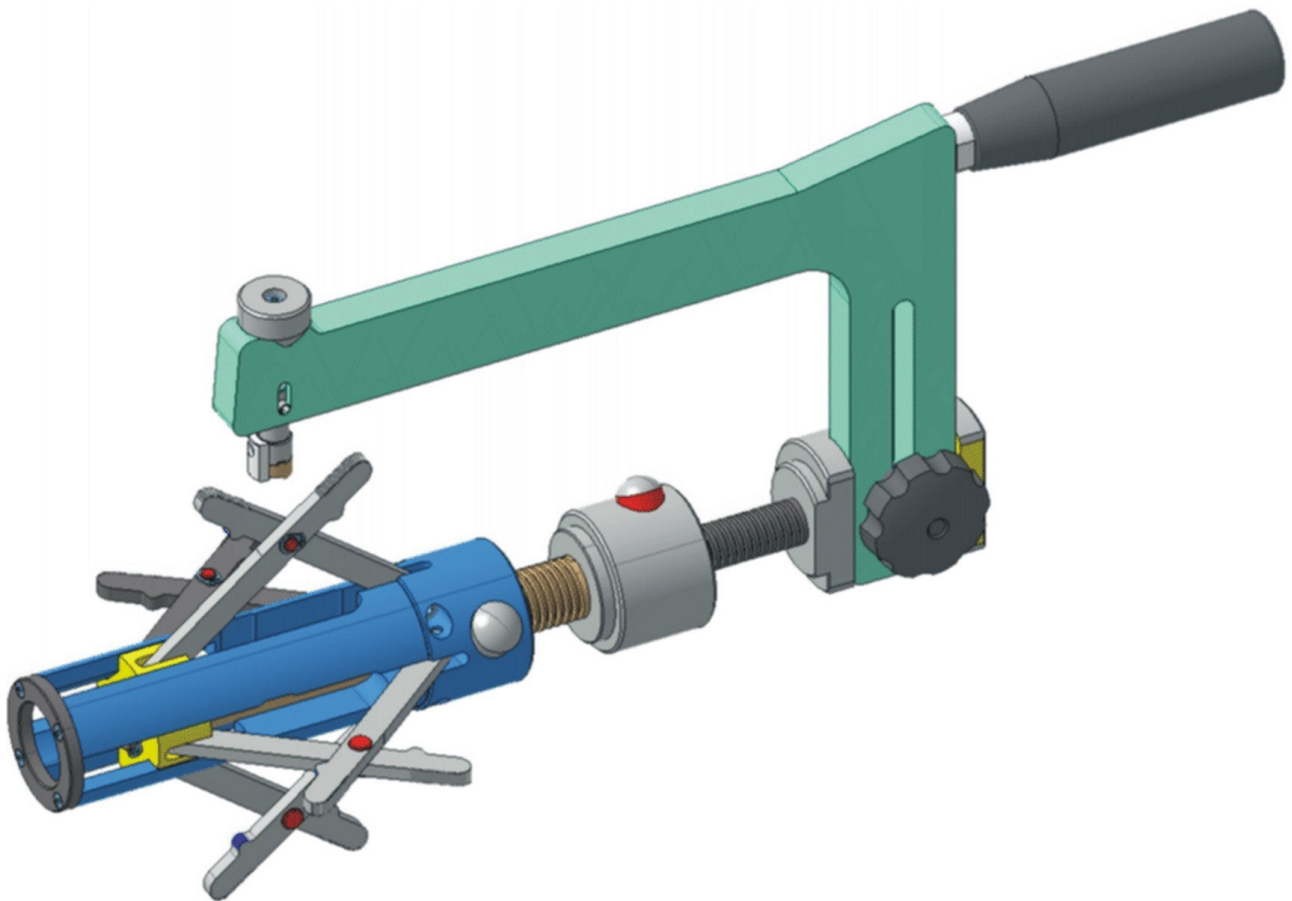

USE AND MAINTENANCE HANDBOOK

Ritmo S.p.A. è libera di apportare modifiche senza preavviso alle caratteristiche della macchina descritta in questo manuale e alle informazioni qui contenute.

I

È vietata la riproduzione, anche parziale e sotto qualsiasi forma, di questo documento.

Ritmo S.p.A. is free to modify the contents of this handbook, as well as the features of the machine described herein, at any time, without notice.

EN

All rights reserved. It is strictly prohibited to reproduce this document or part of it in any form whatsoever.

L'entreprise **Ritmo** S.p.A. se réserve le droit d'apporter, sans préavis, toutes les modifications qu'elle désirera aux caractéristiques de la machine décrite dans ce manuel ainsi qu'aux informations qu'il contient.

F

La reproduction de ce document, même partielle, sous n'importe quelle forme, est strictement interdite.

Ritmo S.p.A. se reserva el derecho de hacer modificaciones sin previo aviso a las características de la máquina descrita en este manual y a las informaciones en él incluidas.

E

Está terminantemente prohibida toda reproducción de este documento, incluso parcial o de cualquier otra

A **Ritmo** S.p.A. pode efectuar sem pré-aviso quaisquer modificações às características da máquina descrita no presente manual, bem como às informações nele inseridas.

P

A cópia total ou parcial deste documento é severamente proibida, sob qualquer forma.

Die hier angegebenen Daten sind ohne Gewähr und **Ritmo** S.p.A. behält sich Änderungen ohne Vorankündigung vor.

D

Die Vervielfertigung, auch auszugsweise, dieses Dokumentes ist verboten.

Ritmo S.p.A. is vrij om de inhoud van deze handleiding en de kenmerken te wijzigen van NL de machine die hierin beschreven wordt, op elke gegeven tijd, zonder waarschuwing. Alle rechten voorbehouden. Het is streng verboden om dit document of een gedeelte ervan in elk vorm dan ook te reproduceren.

NL

Ritmo S.p.A. имеет право вносить изменения в аппарат, описанный в данной инструкции и в информацию о нём без предварительного уведомления.

RUS

Все права защищены. Данный документ и любые его части воспроизводить запрещено.

AR

Ritmo S.p.A. عبارة عن كتيب ذي محتوى قابل للتعديل، كما أن ميزات الآلة الموضحة في هذا الكتيب عرضة للتغيير بدون إشعار مسبق. جميع الحقوق محفوظة. يحظر تمامًا إعادة إنتاج هذا المستند أو أي جزء منه بأي شكل من الأشكال.



Via A. Volta, 35-37 – (Z.I.)
35037 BRESSEO DI TEOLO (PD)
ITALY

Tel. +39.049.990.1888

Fax +39.049.990.1993

info@ritmo.it

INTRODUCTION

Dear Customer,

Thank you for choosing a machine from the **ritmo** range of products.

This manual is designed to illustrate the features and operating methods of your new machine **PS** series. It contains all the necessary information and prescriptions for correct and safe use of the equipment by professional operators. Please read all parts of the manual carefully and keep it in a safe place for future consultation and/or to transfer to any future owners/users of the machine.

We are confident that you will enjoy getting to know your new equipment and will be able to use it profitably for many years to come.

Cordialmente,

Ritmo S.p.A.

FIELDS OF APPLICATION

Pipe scraper is a manual tool with a cutting device for the removal of material from the surface of polyethylene (PE) and polypropylene (PP) in the different dimensions and the fields of application.

Warning

This tool is not for:

- scraping (cleaning) other materials different from polyethylene (PE) and polypropylene (PP);
- making any kind of operation not described by the instructions of the constructor in this manual.

TECHNICAL FEATURES

	PS 180	PS 400
Dimensions	595×272×190 mm (23.4×10.7×7.5 in)	790×400×400 mm (31.1×15.7×15.7 in)
Box dimensions	453×185×63 mm (17.8×7.3×2.5 in)	550×350×90 mm (21.6×13.7×3.5 in)
Total weight	Arm+Body = 2.8 kg (6.2 lb) Arm: 1.4 kg (3.1 lb) Body: 1.4 kg (3.1 lb)	Arm+Body = 5.5 kg (12.1 lb) Arm: 2 kg (4.4 lb) Body: 3.5 kg (7.7 lb)
Working range:		
External diameters	Ø 75 ÷ 200 mm (Ø 2.95 ÷ 7.87 in)	Ø 137 ÷ 426 mm (Ø 5.4 ÷ 16.7 in)
Internal diameters	Ø 61 ÷ 184 mm (Ø 2.40 ÷ 7.24 in)	Ø 130 ÷ 391 mm (Ø 5.1 ÷ 15.3 in)
Max scraping lenght	Ø max = 129 mm (5.1 in) Ø min = 120 mm (4.7 in)	Ø max = 150 mm (5.9 in) Ø min = 160 mm (6.2 in)

PARTS DESCRIPTION

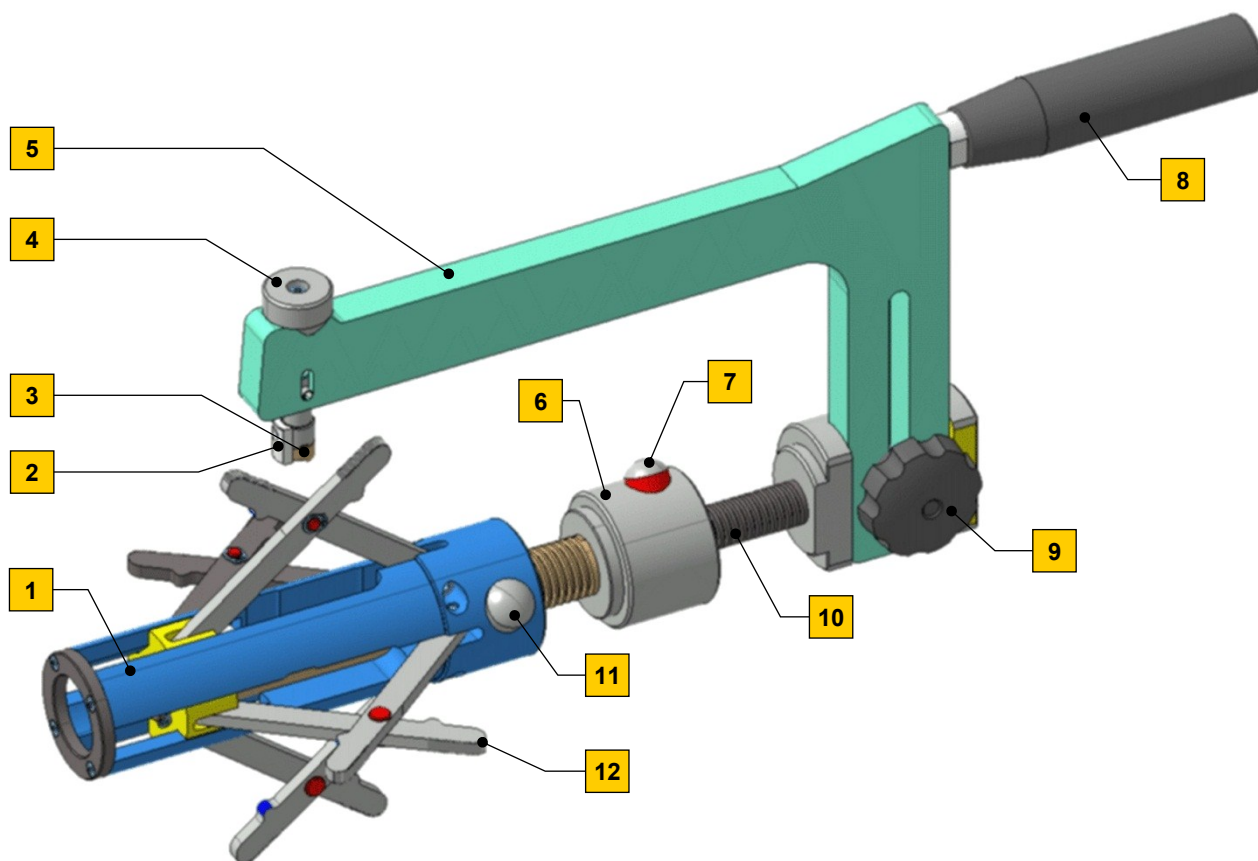

1. scraper body
2. blade guide
3. blade
4. loading wheel
5. arm
6. adjusting handle for locking devices
7. pushbutton for fast sliding of scraper arm
8. scraper arm handle
9. adjusting wheel for telescopic arm
10. screw for scraper forward movement
11. fast button for adjustment of locking devices
12. locking devices

SAFETY INSTRUCTIONS

While using manual equipment, tools and saws, the principal requirements for reducing the risk of injuries are the careful handling, the respect of the instructions for use and of the safety laws in force.

Carelessness and the lack in respecting safety rules can be cause of injuries in the workplace.

Firmly tighten: check that the pipe is firmly tighten to a support (we suggest RITMO product "Inclinable pipe support" cod. 99601000 - fig. 2) and that the scraper is firmly locked in the pipe. A scarce clamping can make the pipe or the support fall compromising the scraping, an excessive clamping of the tool in the pipe can ruin or brake the aluminum clamps; in both cases the situation is dangerous for the operator with the risk of injuries.



Tools maintenance: sharp and clean tools give better results and are safer; carefully read the section about the instructions for the maintenance of this manual. Immediately replace the worn, broken or lost parts; it is not admitted the use of a tool or a machine with components which do not work properly or are missing; worn, broken or lost components can be cause of risk for the operator: the tool can suddenly brake and compromise the safety of the surrounding environment. Carefully place the tool in the special case; a scarce attention may damage the ends of scraper arm, the clamps and the extensions. The clamps, if damaged or dirty, may prevent extensions positioning or a good fixing.

Use suitable work garments: the tool has a little sharp blade: we suggest to wear suitable protective gloves. Avoid to keep belts untied, rags jutting from the pockets, long hair and beard untied: they may get caught in the moving parts endangering the operator and compromising the scraping.

Keep workplace clean: untidy and dirty workplaces, because of their scarce efficiency, are cause of injuries in workplaces: it is necessary to keep clean and tidy workplaces.

WARNING: the tool is supplied with a small blade which can cause injuries to the operator if incorrectly handled.

ritmo S.p.A. is not responsible for damages or injuries to persons caused by the non reading of this manual.

PREPARE THE PIPE

A correct scraping is extended from the edge of the pipe, for a length a little longer than half the length of the fitting. Before starting working it is useful to mark on the pipe the limit of the scraping, bringing the pipe near the fitting and marking the line from which the pipe is uncovered.

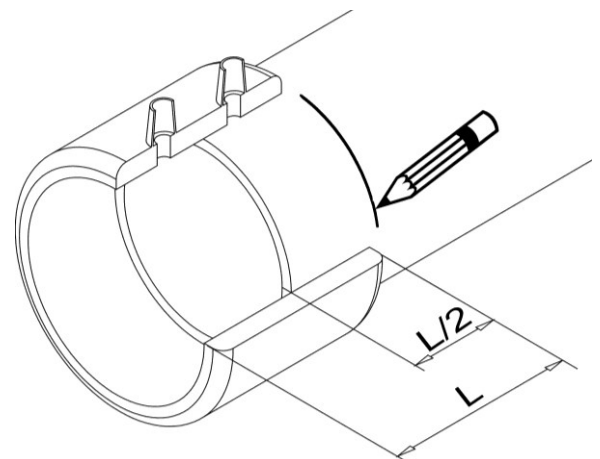

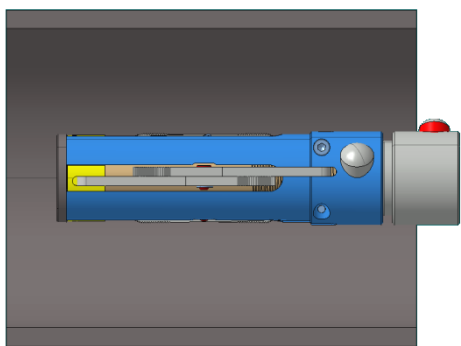

1

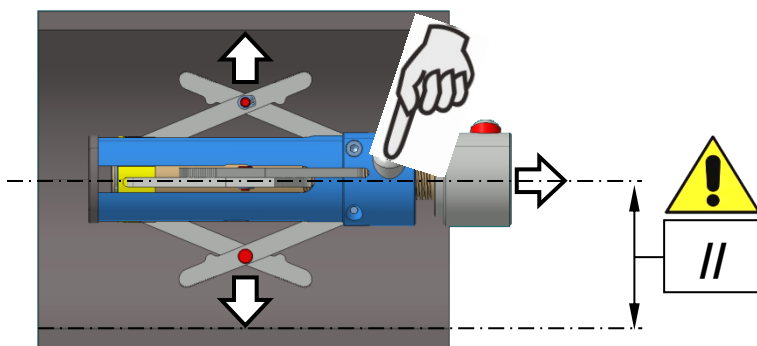

2

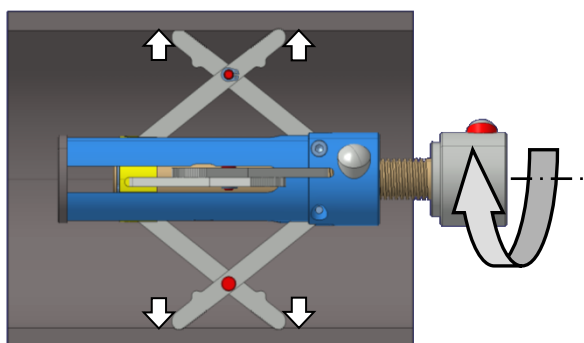

3

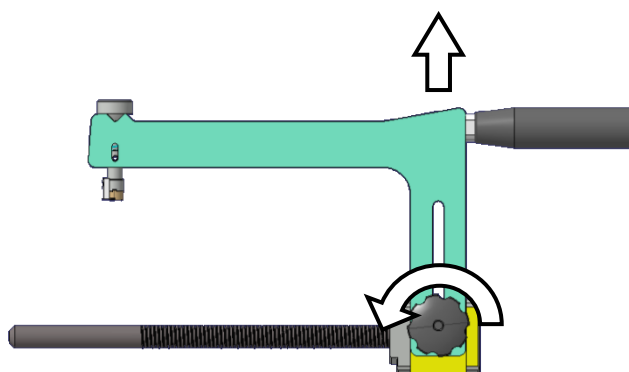

4

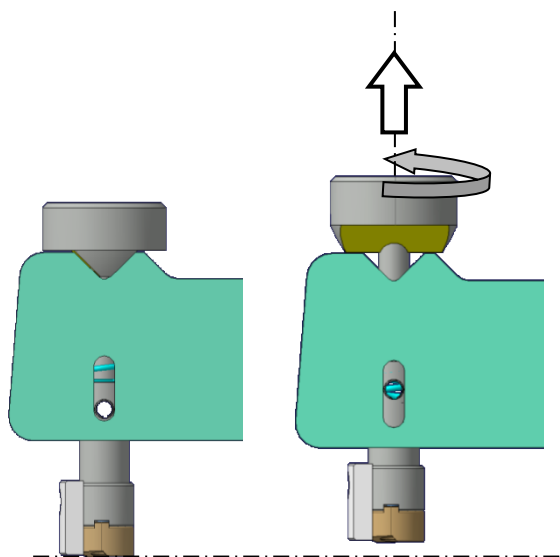
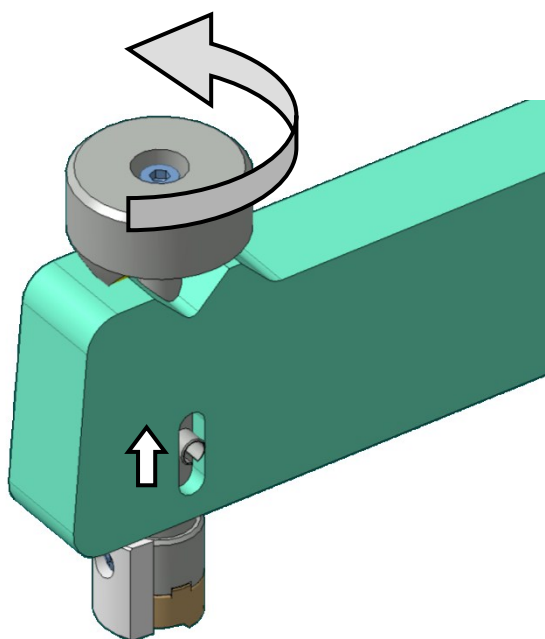

5

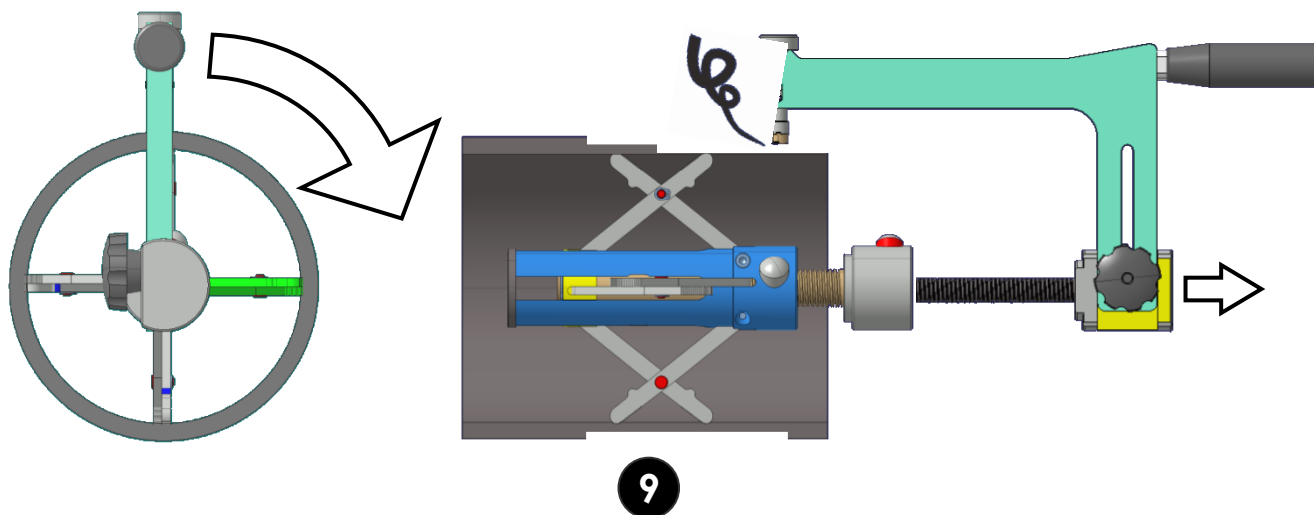
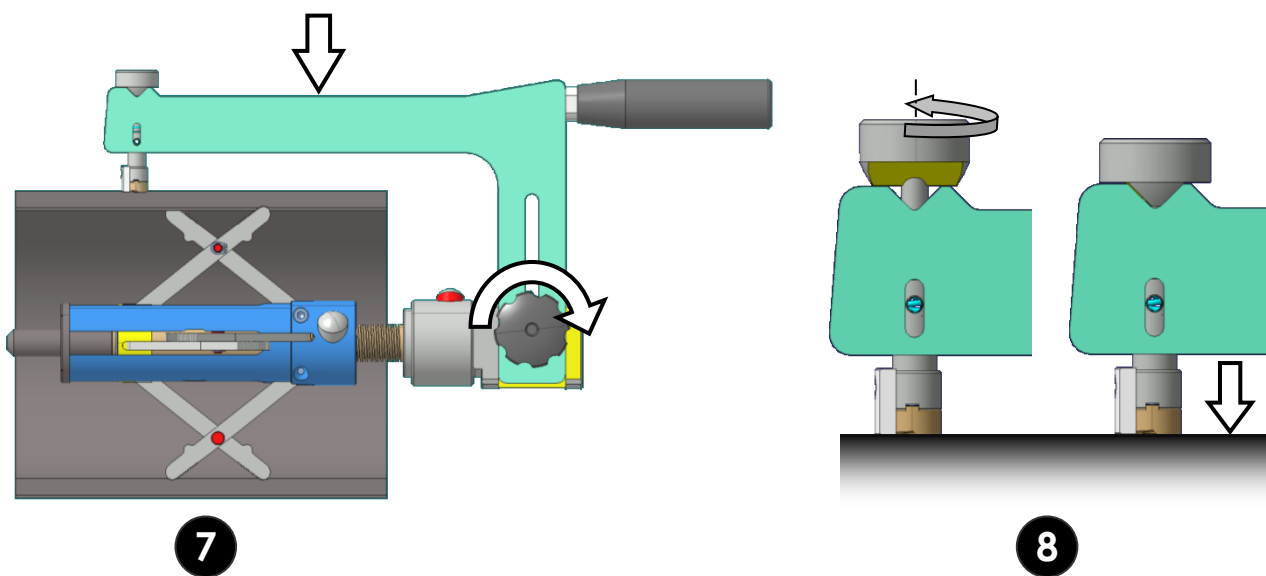
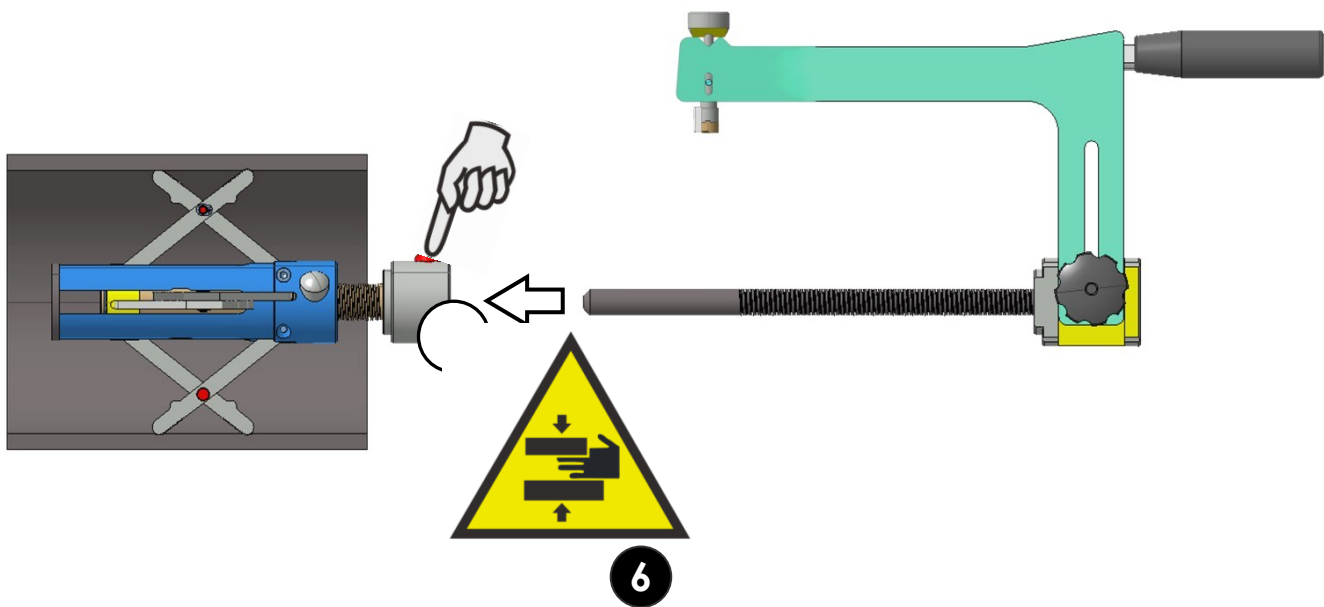

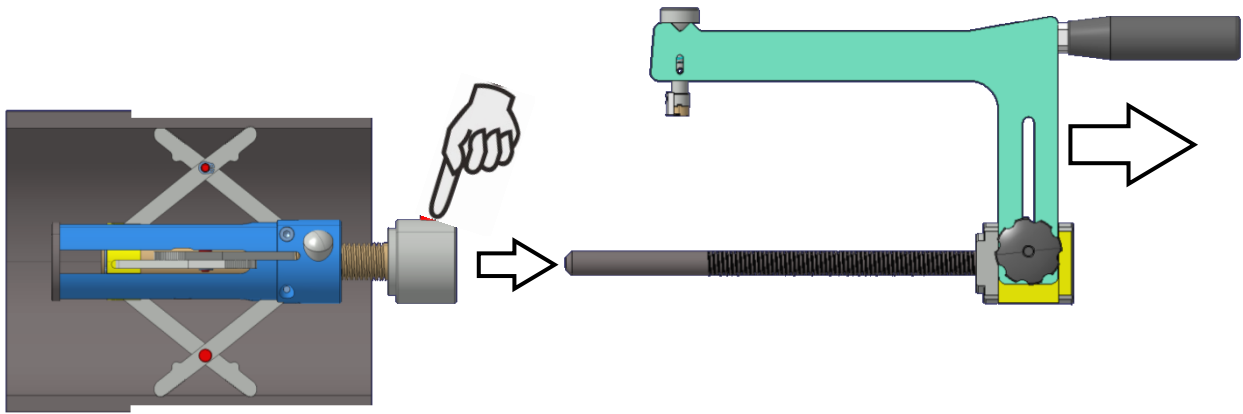

10

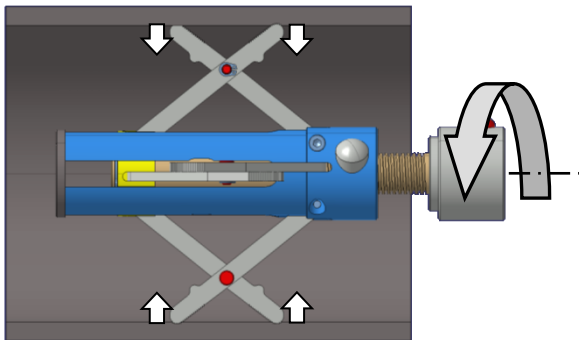

11

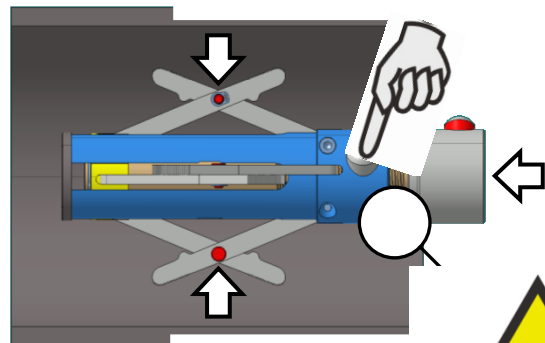

12



13

After scraping operation the end of the pipe has to be chamfered (we suggest to use RITMO "SME 1" chamfering tool for diameters 25÷160mm with max. thickness=10mm and "SME 2 PLUS" for diameters 40÷315mm with max. thickness=35mm), and the internal part of the pipe's end has to be trimmed (we suggest the use of RITMO "Trimming knife"); now pipe is clean and ready to be electrofused.

MAINTENANCE

The pipescraper requires simple maintenance to follow constantly for maintaining the efficiency and safety of the tool itself. The life of the tool and its reliability will be greater if the instructions will be followed.

Keep tool clean paying particular attention to operating screws and to loading wheel (side picture ). For clearing use petrol or diesel, after wearing safety gloves and mask.



After cleaning carefully grease.



USE PROTECTIVE GLOVES

Check efficiency and integrity of blade.
For the replacement simply remove blade guide, remove used blade and place a new one following reverse procedure.

